

# AVAILABLE ADVANTAGESITE SITE

## GATEWAY INDUSTRIAL PARK EAST



6524 State Highway 129, Winfield, Marion, AL, 35594

### Sale / Lease

**For Sale:** Yes  
**Sale Price:** \$ 9,500.00 per acre  
**Pricing Information:** Price is negotiable depending on the type and number of jobs created.

### Zoning

**Zoning:**

### Property Details

**Latitude:** 33.986000  
**Longitude:** -87.772500  
**Total Acreage:** 100 Acre(s)  
**Available Acres:** 100 Acre(s)  
**Largest Tract Available:** 100 Acre(s)  
**Smallest Tract Available:** 5 Acre(s)  
**Expandable:** Yes  
**Wetlands:** Yes  
**Phase 1 Audit Done:** Yes

### Description

LOCATED IN AN OPPORTUNITY ZONE. Contact David Thornell email: [dthornell@northwestalabamaeda.org](mailto:dthornell@northwestalabamaeda.org) or call (205)468-3213



**For more information, please contact:**

C3 of Northwest Alabama Economic Development Alliance  
David Thornell  
(205) 468-3213  
[dthornell@northwestalabamaeda.org](mailto:dthornell@northwestalabamaeda.org)

Economic Development Partnership of Alabama  
1320 1st Avenue South  
Birmingham, AL 35233  
P 205.943.4700  
[gblalock@edpa.org](mailto:gblalock@edpa.org)  
<https://www.edpa.org>

# AVAILABLE ADVANTAGESITE SITE

## GATEWAY INDUSTRIAL PARK EAST



6524 State Highway 129, Winfield, Marion, AL, 35594

### Interstate/Highway

**Interstate:** I-22  
**To Interstate (miles):** 1 Mile(s)  
**Interstate #2:** I-65  
**To Interstate #2 (miles):** 62.00 Mile(s)  
**Highway:** 129  
**To Highway (miles):** On-Site

### Rail

**Carrier:**

### Electric

**Provider:** Tombigbee Electric Co-op

### Natural Gas

**Provider:** NW Alabama Gas District  
**Pressure (bars):** 300 Psi  
**Size of Main:** 6"

### Water

**Provider:** Winfield Water Works  
**Size of Main:** 8"

### Telecommunications

**Provider:** CenturyLink  
**Fiber Available:** Yes  
**DSL Available:** Yes

### Sewer

**Provider:**  
**Size of Main:** 8"



**For more information, please contact:**

**C3 of Northwest Alabama Economic Development Alliance**  
**David Thornell**  
**(205) 468-3213**  
**dthornell@northwestalabamaeda.org**

**Economic Development Partnership of Alabama**  
**1320 1st Avenue South**  
**Birmingham, AL 35233**  
**P 205.943.4700**  
**gblalock@edpa.org**  
**<https://www.edpa.org>**

# AVAILABLE ADVANTAGESITE SITE

## GATEWAY INDUSTRIAL PARK EAST



6524 State Highway 129, Winfield, Marion, AL, 35594

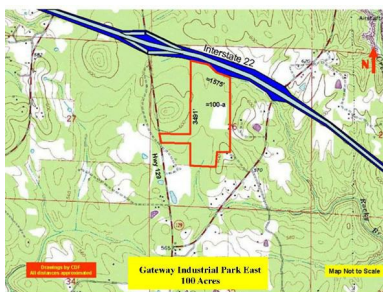
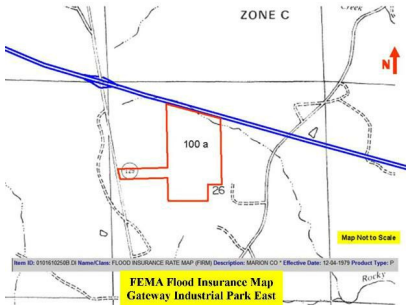

For more information, please contact:

C3 of Northwest Alabama Economic  
Development Alliance  
David Thornell  
(205) 468-3213  
dthornell@northwestalabamaeda.org

Economic Development Partnership of  
Alabama  
1320 1st Avenue South  
Birmingham, AL 35233  
P 205.943.4700  
gblalock@edpa.org  
<https://www.edpa.org>